

# G4 Pro[TI]

## 4G Multi-Biometric Access Control Terminal With Thermal Imaging Temperature Detection

Compatible with



Compatible with

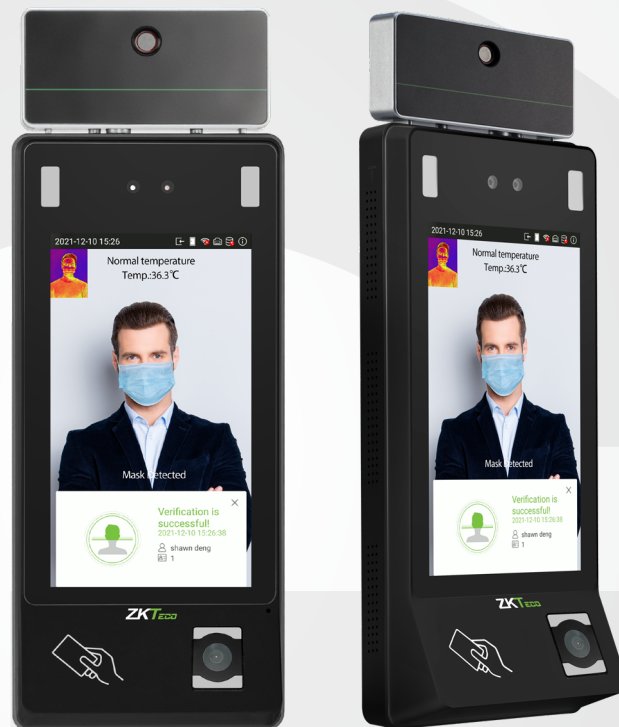

**G4 Pro[TI]** is an upgraded version of the G4 Pro Visible Light Facial Recognition Terminal with Temperature Detection using intelligent engineering facial recognition algorithms and the latest computer vision technology.

**G4 Pro[TI]** is equipped with a fully upgraded version of the Android 9.0 system, adding new features such as palm recognition, PoE power supply, and it is compatible with 4G network, satisfying various market needs including Europe, the Middle East, Africa, South Korea, Thailand, and India.

Resembles G4, G4 Pro is equipped with ZKTeco's enhanced Visible Light Facial Recognition technology. Also, G4Pro has installed a new mini QR code reader to scan T&A/A&C dynamic QR codes on the ZKBioSecurity mobile application. The reader supports QR code, PDF417, Data Matrix, MicroPDF417, Aztec scanning in third-party development projects.

Through the fast and accurate body temperature measurement and masked individual identification functions, G4[TI] is a perfect choice to help reduce the spread of germs and help prevent infections straightly at each access point of any premises and public areas, such as hospitals, factories, schools, commercial buildings, stations.

ZKTeco also provides an LCDP tool which is used for 3rd party applications integration. It includes simplified bottom hardware interface which enhances efficiency.

## Features

- Compatible with 4G network, supported E.U. , UAE, Africa, South Korea, Thailand, India, etc.
- Scanning of T&A/A&C dynamic QR codes on the ZKBioSecurity Mobile App
- Open Supervised Device Protocol (OSDP v2.1.7)
- Dual-frequency (125kHz and 13.56MHz) card module (standard)
- Support Multi-tech card module (optional)
- Android LCDP demo for the 3rd-party application integration
- IEEE 802.3af/at PoE (Power over Ethernet) power supply
- Mask detection
- Anti-spoofing algorithm against print attack (laser, color, and B/W photos) and video attack

\* Facial recognition for masked individuals will increase the rate of FAR(%). Palm verification for masked individuals is recommended.

## Body Temperature Detection Specifications

Preventative Measures	Mask detection/Body temperature detection
Temperature Measurement Distance	50cm to 120cm(1.64ft to 3.94ft)
Temperature Measurement Accuracy	±0.3°C (±0.56°F)
Temperature Measurement Range	20°C to 50°C (68°F to 122°F)

## Specifications (GL: GL Exclusive Feature)

### Capacity

30,000 Users (optional 50,000)  
GL 30,000 Faces (optional 50,000)  
30,000 Cards (optional 50,000)  
GL 3,000 Palms (optional 6,000)  
GL 1,000,000 Transactions

### CPU

64bit Eight Core Customized Computer Vision CPU

### Storage

2GB LPDDR3  
16GB eMMC

### Screen

7-inch Touch Screen  
720\*1280 Pixels

### Camera

2MP Binocular Camera

### Communication

TCP/IP, USB Host, RS485, Wiegand Input, Wiegand Output, Wi-Fi, Bluetooth, 4G  
WLAN: 2.4G, 802.11 b/g/n  
GL Bluetooth: BT2.1+EDR/3.0/4.1 LE/4.2 BLE  
GL LTE FDD: B1/B2/B3/B4/B5/B7/B8/B20/B28  
GL LTE TDD: B38/B39/B40/B41  
GL WCDMA: B1/B2/B4/B5/B8

GSM: 850/900/1800/1900MHz

### Access Control Interface

RS485 (OSDP v2.1.7), Wiegand In/Out, Lock Relay Output, Exit Button, Alarm Output, Auxiliary Input, Door Sensor, External Bell

### Card

125kHz ID card & 13.56MHz IC card  
Multi-tech Card Module(optional)

### QR Code Scanner

Dynamic QR codes on the ZKBioSecurity mobile application  
QR code, PDF417, Data Matrix, MicroPDF417, Aztec scanning in third-party development projects

### Fingerprint

GL SilkID Fingerprint Sensor (optional)  
GL 10,000 Fingerprints (optional 30,000)

### Algorithms

ZKFace 5.6  
ZKFinger 10.0  
ZKPalm

### Palm

FAR ≤0.01%; FRR ≤1%

### Operating Temperature

-20°C to 55°C (-4°F to 131°F)

### Operating Humidity

<90%RH

### Storage Temperature

-25°C to 65°C (-13°F to 149°F)

### Storage Humidity

<90%

### Dimensions (H\*L\*D)

319.5mm\*120mm\*51 mm (12.58in\*4.72in\*2 in)

### Facial Recognition Speed

≤ 0.5s

### Facial Recognition Distance

0.5m to 3m

### Power supply

DC 12V, 3A  
GL IEEE 802.3af/at

### Standard Firmware Functions

Push, Schedule Bell, Automatic Status Switch, Record Query, Access Levels, Groups, Holidays, DST, Duress Mode (Password & Fingerprint), Anti-Passback, Customization of Wallpaper & Screen Saver

### Software

BioTime 8.0 (Only Time & Attendance Firmware)  
ZKBioSecurity (Only Access Control Firmware)

## Configuration

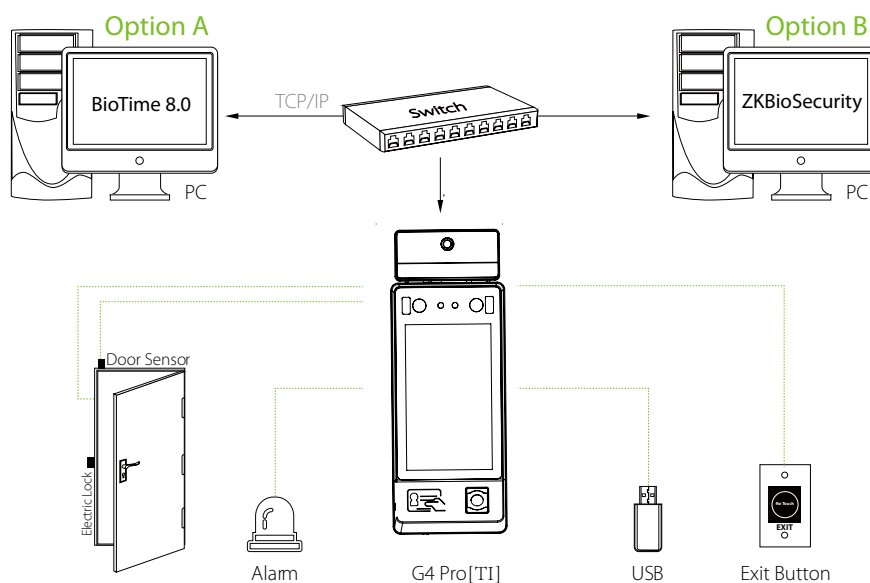

## Dimensions (mm)

