

QUICK START GUIDE

PA10 Fingerprint & Palm Terminal

Time Attendance & Access Control

Version: 1.0

Date: August,2017

1 Overview

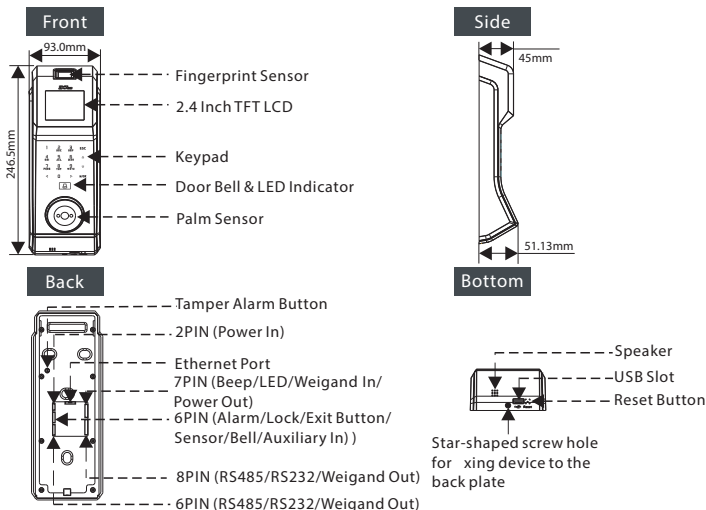

2 Installation of Wall-mount

Before the installation, please connect the cables to the connectors. (Recommended installation height: 1.1m)

- 1) Post the installation template on the wall and drill.
- 2) Fix back plate to the wall.
- 3) Mount the device on the back plate.
- 4) Secure the device and back plate.

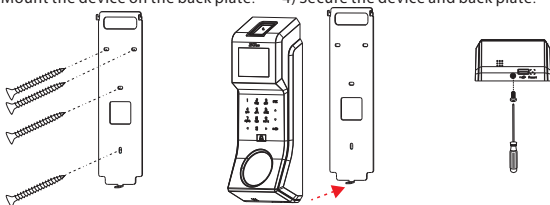

3 Cautions

- 1) Power cable is connected after other wirings, and shut down the power firstly, when making some necessary checking.
- 2) We recommend that use the DC12V/3A power supply.
- 3) Please read the terminals description carefully and wiring by rule strictly.
- 4) Please connect the GND before other wirings especially under the serious electrostatic environment.

5) Do not install the device in a place subject to direct sunlight, humidity or dust.

4 Wiring Diagram

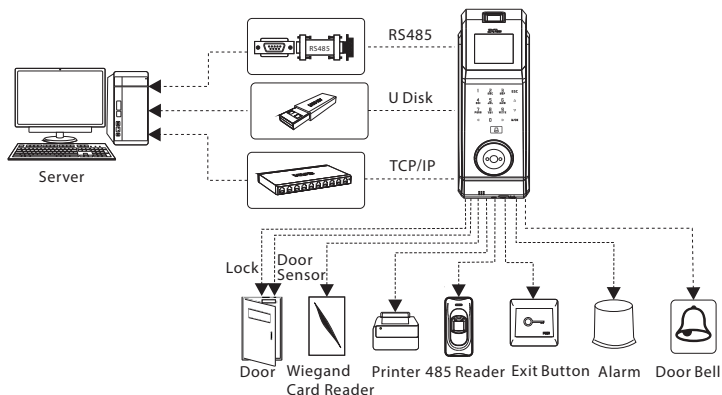

5 Door Bell & Door Sensor & Exit Button & Alarm Connection

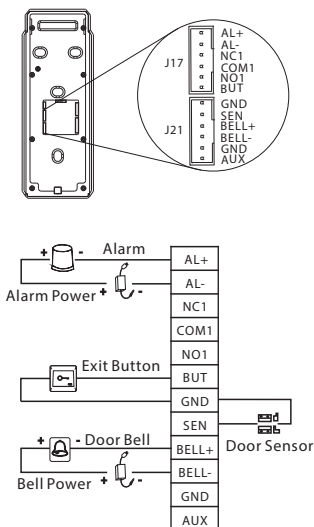

Description		Color
Alarm	AL+	Red
Alarm	AL-	Black
Normal Close	NC1	Gray
COMM	COM1	Black
Normal Open	No1	White
Button	BUT	Blue
Ground	GND	Red
Sensor	SEN	Yellow
Bell	BELL+	Orange
Bell	BELL-	Green
Ground	GND	Purple
Auxiliary	AUX	Brown

6 485 Reader Connection

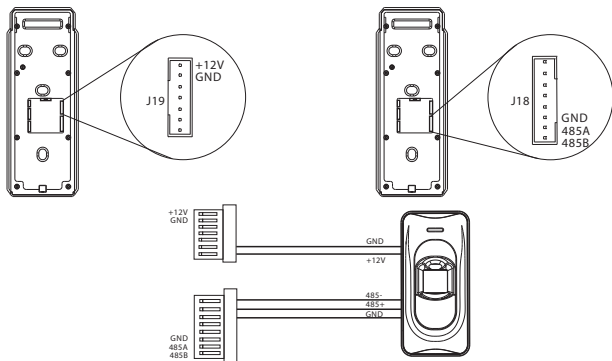

How to enable 485 Reader Function?

1. Enable RS485 Reader Function: Press M/OK > Comm. > Serial Comm > Serial port, select [master unit].
2. Setting 485 Reader verification mode: Press M/OK > Access Control > Access Control Options > Verify mode by RS485, to choose verification mode.

7 Wiegand Card Reader Connection

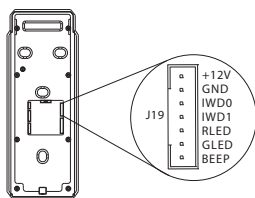

Description		Color
Power Out	+12V	Red
Ground	GND	Black
Wiegand In	IWD0	White
Wiegand In	IWD1	Green
Red LED	RLED	Blue
Green LED	GLED	Gray
Beep	BEEP	Purple

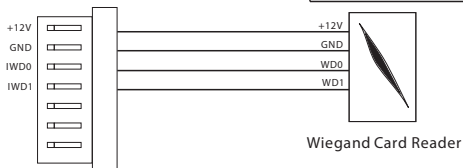

8 Power Connection

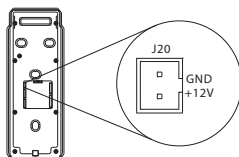

Description	Color
Ground GND	Black
Power In +12V	Red

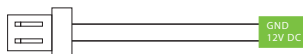

12V \pm 10%, at least 500mA.

To share the power with other devices, use a power supply with higher current ratings.

9 Printer Connection

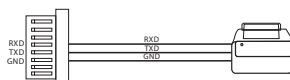
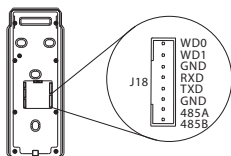

10 Communication with PC Via Ethernet Cable

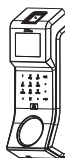

To connect device with a PC directly, connect both devices with a straight network cable. Such as the following figure.

IP Address: 192.168.1.201
Subnet Mask: 255.255.255.0



IP Address: 192.168.1.130
Subnet Mask: 255.255.255.0

11 Lock Relay Connection

1. The device supports "Dry Mode" and "Wet Mode" by setting the jumper. The factory default jumper setting is set as "Dry Mode", that is, shorten 1-2 and 3-4 .
2. If there is no enough power supply under the working circumstance, "Wet Mode" can also be used, namely, shorten 2-3 and 4-5 .
3. If you want to switch "Dry Mode" to "Wet Mode", you must take off the jumpers and plug them.

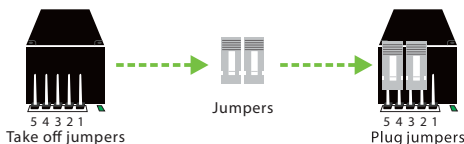

12 Date/Time Setting

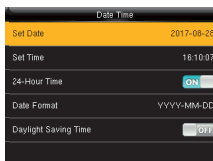
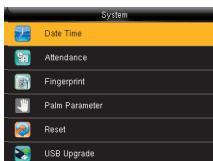

Press M/OK > System > Date Time to enter the Date Time interface.

13 Adding a User

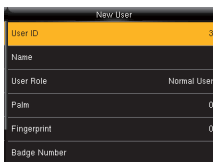
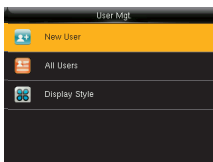

Press M/OK > User Mgt. > New User to enter the New User interface.

The setting include entering a name, modifying user roles (Super Admin / Normal User), enrolling fingerprint/palm/badge number ★ /password, modifying access control role.
Adding a Super Admin: Select Super Admin in User Role to add a super admin.
Adding a Normal User: Select Normal User in User Role to add a normal user.

14 Ethernet Setting

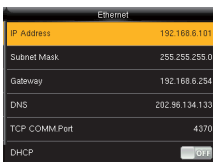

Press M/OK > Comm. > Ethernet to enter the Ethernet interface.

The Parameters below are the factory default values. Please adjust them according to the actual network.

IP Address: 192.168.1.201

Subnet Mask: 255.255.255.0

Gateway: 0.0.0.0

DNS: 0.0.0.0

TCP COMM. Port: 4370

DHCP: Dynamic Host Configuration Protocol, which is to dynamically allocate IP addresses for clients via server. If DHCP is enabled, IP cannot be set manually.

Display in Status Bar: To set whether to display the network icon on the status bar.

15 Access Control Setting

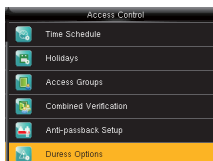
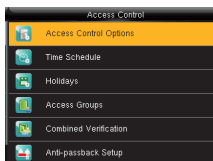

Press M/OK > Access Control to enter the Access Control interface.

To unlock, the enrolled user must accord with the following conditions:

- 1) The current unlock time should be in the effective time of user time zone or group zone.
- 2) The group which user is must be in Combined Verification.

Access Control Options: Set parameters to control locks and related device.

Time Zone: It is the minimum unit of access control option.

Holidays: Set some days as holidays, and then set Time Schedule of those days.

Access Groups: Grouping is to manage employees in groups. Employee in groups use group time zone by default. Group members can also set user time zone.

Combined Verification: Make various groups into different access controls to achieve multi-verification and improve security.

Anti-pass Back: To prevent someone following the employee into the company.

Duress alarm parameter: The device will open the door as usual, but the alarm signal will be sent to backstage alarm when employee comes across duress.

16 Auxiliary Input Setting

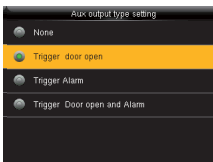
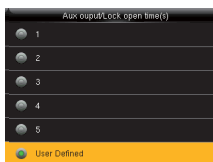
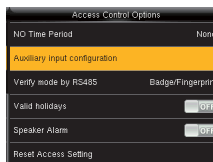

Press M/OK > Access Control > Access Control Options > Auxiliary input configuration.

Auxiliary Output/Lock open Time: It is defined as the time interval between the lock receiving signals and automatically closing under Normal Closed mode.

Auxiliary Output Types

Trigger Door open: The lock will turn to Normally Open after the device receives signals.

Trigger Alarm: The alarm will be triggered after the device receives signals.

Trigger Door open and Alarm: The lock will turn to Normal Open and the alarm will be triggered after the device receives signals.

17 Disabled Slide Show



Press M/OK > Personalize > User Interface, set Idle Time To Slide Show(s) to be None, or set Slide Show Interval(s) to be disabled.

18 Trouble shooting

1) Fingerprint can not be read or it takes too long.

- Check whether a finger or fingerprint sensor is stained with sweat, water, or dust.
- Retry after wiping off finger and fingerprint sensor with dry paper tissue or a mildly wet cloth.
- If a fingerprint is too dry, blow on the finger and retry.

2) Fingerprint is verified but authorization keeps failing.

- Check whether the user is restricted by door zone or time zone.
- 3) Authorized but door does not open.
 - Check the user role is permissible.
 - Check the lock connection is corrected.

4) When the device is tampered, the device will send a signal to the speaker then the icon  is displayed on the top right corner and the speaker is ringing. Only the [Speaker Alarm] (Access Control > Access Control Options > Speaker Alarm) is [ON] can user heard the ringing.

- Please install the device properly.