

Quick Setup Guide

Video Recorder

Version: 2017.11

Thank you for purchasing our products !

Declaration :

This manual may contain inaccurate data or printing error.

The products described in this manual may be updated at any time.

Screenshots of the manual is not in a machine and only for display.

If in doubt, obtaining a copy of the latest procedure or the additional document, please contact with the company's after-sales department.

Important Safeguards and Warnings

1. Electrical safety

All installation and operation should conform to your local electrical safety codes.

We assume no liability or responsibility for any fires or electrical shock caused by improper handling or installation.

2. Transportation security

Heavy stress, violent vibration or water splash should be avoided during transportation, storage and installation.

3. Installation

Keep upright. Handle with care.

Do not apply power to the DVR before completing installation.

Do not place objects on top of the DVR

4. Qualified engineers needed

All examination and repair work should be done by qualified service engineers.

We are not liable for any problems caused by unauthorized modifications or attempted repair.

5. Environment

The DVR should be installed in a cool, dry place away from direct sunlight and inflammable or explosive substances, etc.

This product should be transported, stored and operated in an environment ranging from 0°C to 55 °C.

6. Accessories

Before installation, please open the package and check all the components are included.

Contact your local Maplin outlet if something is broken or missing in your package.

7. Lithium battery

Improper battery use may result in fire, explosion, or personal injury.

When replacing the battery, please make sure you use the same model. (CR2032 Motherboard battery).

Contents

1 Installation	5
1.1 Unpacking Inspection	5
1.2 HDD Installation	5
1.3 The Front Panel Instruction.....	6
1.4 The Rear Panel Instruction.....	9
1.5 Alarm Connection	11
1.5.1 Alarm Input Connection	11
1.5.2 Alarm Output Connection.....	12
1.6 PTZ Connection	12
2 Basic Operation Guide	14
2.1 Power On	14
2.2 Power Off	14
2.3 Log In.....	15
2.4 Preview	15

2.5 Channel Management	16
2.5.1 Mode Switch	17
2.5.2 IP Channel	17
2.5.3 Video Encode Configuration	18
2.6 PTZ Control	20
2.7 Playback	20
2.8 Network	23
2.8.1 Network Setting	23
2.8.2 WEB Access	24
2.8.3 Client Access	25
3 Statement	27

1 Installation

1.1 Unpacking Inspection

When you receive the product please check that all items are present according to the packing list on the reverse of the box.

1.2 HDD Installation

Tools: A cross screwdriver



① Remove the screws of the device and disassemble the cover

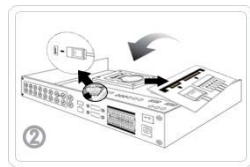

② Install the HDD into the HDD bracket and connect the HDD cable

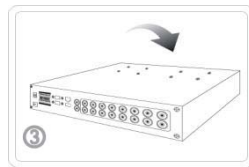

③ Fix the HDD at the bottom of the chassis

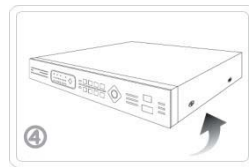

④ Close the cover and assemble the screws to fix the cover

1、The environment temperature should below 35°C.

2、 Make sure has a 15 cm (6 inches) space around the device to ventilate.



The initial installation please check whether has installed HDD. There are several interfaces it means you can install several SATA interface HDDs.



Note: 1、 Our equipment will format the HDD once it boot up, please back up the HDD data.





2、 The notes for purchasing HDD: We recommend that to use the surveillance HDD. It is suitable for long time, large amount of data to read and write. Please purchase from the official channels to ensure the quality.

1.3 The Front Panel Instruction

Note: different modes with different features. Please make the material object as the standard.

Name	Identification	Description
Power Switch		Power button, press this button to boot up or shut down DVR/NVR.
USB Port		USB2.0 interface: 1、 Connecting mouse to menu operate; 2、 Connecting U-disk to backup video or upgrade the firmware.
Menu	Menu	Pop up the menu interface.
Rec		Start Recording.

Direction Key		1.Assistant function such as PTZ menu; 2.In monitor mode, switch between multiple-window and one-window; 3. Activate the digital input box increase or decrease the number; 4.Active pull-down menu to switch the drop-down box options; 5. Activate checkbox to change status; 6. Activate the text input box and step down carry and abdication; 7. Activate the control box to move the slider; 8. Activate display window to select the previous channel, next channel.
Enter	Enter、OK	1. Confirm current operation; 2. Go to OK button; 3. Go to menu.
ESC	Esc、 	Go to previous menu, or cancel current operation.
Shirt	Shift	1. In input Box, switch input methods; 2. Switch TAB;
Auxiliary	Fn	1. One-window monitor mode, click this button to display assistant function: PTZ control and image color; 2. Detection areas setting(like in motion detection setup), working with

		<p>Fn and direction keys to realize setup;</p> <p>3. In text mode, click it to delete the character before the caret(if there is no shift on the front panel, it can switch input methods), press this button for 1.5sec to clear all of the characters;</p> <p>4. In playback mode, switch the full screen;</p> <p>5. Realize other special functions.</p>
Play/Pause		<p>1. Go to SEARCH interface;</p> <p>2. In PTZ channel: ZOOM+;</p> <p>3. In normal playback click this button to pause playback;</p> <p>4. In pause mode, click this button to resume playback.</p>
Fast / backward playback		Multiple fast play speeds or backward playback.
Previous/ Next Record		Playback the next video or previous record.
Shuttle		<p>In real-time monitor mode:</p> <p>Shuttle (outer ring) works as left/right direction key.</p> <p>Jog (inner dial) works as up/down direction key.</p>

Power Light	Power	Red, light on means powered.
HDD Light	HDD	No HDD, HDD error, the light will be turned on.
Net Light	Net	Connect the network cable, the light on; IP conflict, the light flashing.
Rec Light	Rec	Recording, the light on.
IR	IR	Receive the remote control signal.
Alarm Light	Alarm	The alarm is triggered, the light on.
Recording Light	1~16	Blue, the channel is recording.

1.4 The Rear Panel Instruction

Note: different modes with different features. Please make the material object as the standard.

Identification	Name	Description
Video In	Video In	The composite video signal (CVBS) input interface.
Audio In	Audio In	The audio signal input interface.
Line In	Line In	Both-way talk interface.
Video Out	Video Out	The video signal output interface.
Audio Out	Audio Out	The audio signal output interface.

VGA	VGA Interface	Video output interface.
HDMI	HDMI Interface	High resolution video output interface.
Video Spot	Video Auxiliary Output	Video auxiliary output interface, from this interface not support menu
USB	USB Interface	USB2.0 interface: 1、Connecting mouse to menu operate; 2、Connecting U-disk to backup video or upgrade the firmware.
LAN	LAN Interface	10M/100M self-adaptive Ethernet interface (RJ45)
A、B	RS-485 Interface	485 communication port. They are used to control devices such as
RS232	RS-232 Interface	Connecting devices, such as serial keyboard.
Alarm 1、2、3...	Alarm In	Alarm input interface, forward to the video channels.
Alarm G	Ground Interface	Connect the negative end (-) of the alarm input device to the ground.
Alarm NO/NC/C	Alarm Output	NC means always off, NO means always on, C means common port.
DC/AC	Power In	DC 12V/2A、DC 12V/3.3A、DC 12V/4A、AC220V
Switch	Power Switch	Power On/Off.

1.5 Alarm Connection

Name	Description	Name	Description
A、B	RS485 interface	NO1、C	Alarm out
NO2、C	Alarm out	NO3、C	Alarm out
NO4、C	Alarm out	1—8	Alarm in
G	Ground interface		

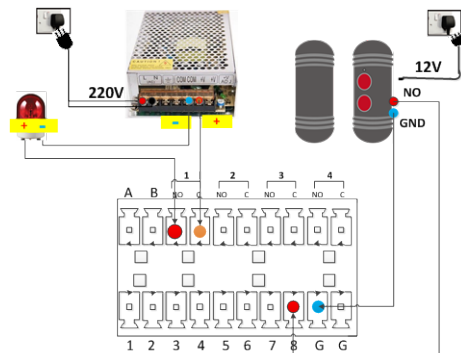

1.5.1 Alarm Input Connection

- 1、The alarm input signal is a switch signal. Support both normal open type and normal close type.
- 2、The alarm detector's Ground-terminal and the DVR's Ground-terminal should be shunt connection.
- 3、The alarm detector's NO-terminal connected to the DVR's alarm input interface.

4、The alarm detector should be connected to the DVR's Ground-terminal once the detector powered by the external power supply.

Note: the graphic for the normal close alarm detector connected to the DVR.

1.5.2 Alarm Output Connection

The alarm output signal is a switch signal. Default is normal open. The alarm output equipment should have an external power supply.

1.6 PTZ Connection

The PTZ's "+" terminal should be connected to the DVR's "A" terminal; "-" terminal should be connected to the DVR's "B" terminal.

1、The PTZ's video output interface should be connected to the DVR's video in interface.

2、Powered the PTZ.

3、Choose the correct PTZ protocol in menu [CONFIG]-[CHANNEL]-[P/T/Z]

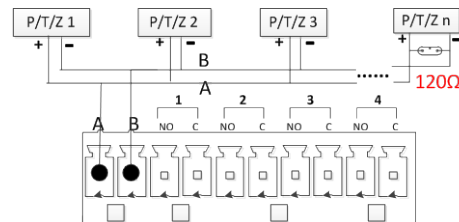

Note: 120Ω resistors should be paralleled in the remote A, B lines to reduce the distortion of the signal if a larger number of PTZs are connected.

2 Basic Operation Guide

2.1 Power On

Install the DVR/NVR correctly (as above) and then connect the power. The DVR/NVR LED should light up and the DVR/NVR will boot automatically.

The DVR/NVR will automatically detect any connected hardware (cameras, monitors, etc.), this process should last about 20 Seconds. You will hear “beep” sound. That means the process has completed. The DVR/NVR will enter into the multi-screen real-time surveillance mode. If the current time which the DVR/NVR displayed is in the recording plan time period, the DVR/NVR will start recording based on the plan.

2.2 Power Off

There are two ways to shut down the DVR/NVR:

- 1、Right mouse click -[Main Menu]-[Shut Down].
- 2、 If there are buttons on the front panel, press the switch button to shut down.

2.3 Log In

Right click to log in menu. Enter username and password.

Note: the default administrator account is admin, the default password is 123456. Users can modify the password but the authority. The administrator can add, delete modify other accounts' parameters.

Password: if enter error password more than 6 times, the DVR/NVR will beep, and the account will be locked. Shut down the device then re-power it or leave the device about 5 minutes, the account will unlock automatically. To be safety, we recommend you to modify the password before settings.

2.4 Preview











After you logged in, the system is in live viewing mode. You can see system date, time, channel name.

A dark-themed dialog box titled "System Login". It contains two input fields: "User Name" with a dropdown menu showing "admin" and a "Password" field. At the bottom are "OK" and "Cancel" buttons.

Login



Preview

	Instant playback		Manual record, instant back the current video to the U-disk
	Snapshot and backup to U-disk.		Channel toolbar is temporarily closed within 30 seconds.
	Audio switch		Screens round of the tour
	Recording status		Video loss
	Motion detection		Preview authority locked

2.5 Channel Management

[Main Menu]-[CHANNEL] to set the channel's parameters.

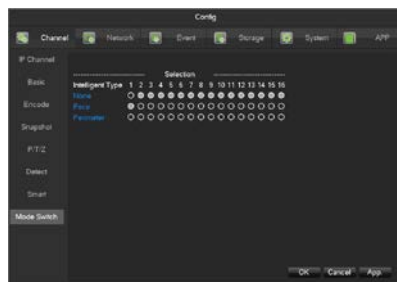

2.5.1 Mode Switch

[Auto] The DVR will identify the camera's video standard and resolution automatically.

[IP Cam] You can add IP cameras in **[IP Channel]** menu if the channel mode is [IP Cam].

[Intelligent Type] This is the local intelligent, the rule setting please check the user manual.

Note: Features in the image is only available on certain devices. Image in this section showing the device's menu system may differ to menu system on the device you are using.

2.5.2 IP Channel

[Batch Add] Click **[Search]** button to search out the IP equipment in the LAN, and tick the checkbox to select the IP equipment, then click **[Add]** button to add them.

[Manual Add] Click **[Add]** button, then enter the correct parameters to add the IP equipment.

[Search] Search all the IP equipment in the network environment.

[Open UPnP] Click the button, cameras in the LAN will be added automatically.

[Status] Click the button will pop up a new interface to show the IP channel status.

[Advanced] Click the [advanced edit] button can modify the front-end equipment's parameters.

Note: Features in this section only for the devices that support IP channels.

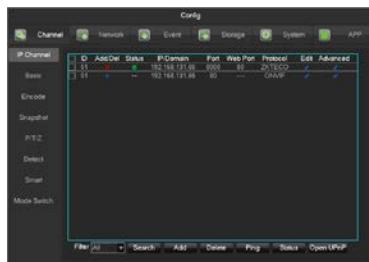

2.5.3 Video Encode Configuration

Right click the mouse to access into **[Main Menu]-[CHANNEL]-[Encode]** to configure the encoding parameters.

[Compression] H.264/H.265.

[Resolution] Choose main resolution and sub resolution.

[Frame Rate] 1~25FPS/PAL,1~30FPS/NTSC.

[Max BitRate] Support adjusting the biggest bit rate. The video bit rate will fluctuate a little.

[Audio] Select the current audio encoding.

Note: Features in the image is only available on certain devices. Image in this section showing the device's menu system may differ to menu system on the device you are using.



2.6 PTZ Control

Follow the bellow steps to control PTZ.

- 1、 Access into **[Main Menu]-[CHENNAL]-[PTZ]** to set the parameters, protocol, address, etc.
- 2、 Right Click the mouse, click [P/T/Z] in the right-click menu to access the PTZ control interface.

[Speed] The value range is 1~8. The value is bigger, the extent is bigger.

[Zoom] [Focus] [Iris] Click 、 to adjust.

[Present] Enter present figure in box and click “Present” button to call present function.

[Tour] Enter cruise figure in box and click “Cruise” button to call cruise between points function.

[Pattern] Enter patrol figure in box and click “Patrol” button to call patrol function.

Note: NVR adds IP PTZ, no need to do the step 1.



P/T/Z Control

2.7 Playback

Accessing into **[Main Menu]-[Search]** to do the playback operations.

Note: the HDD must be the R/W HDD or Read HDD, the file in the HDD can be playback.

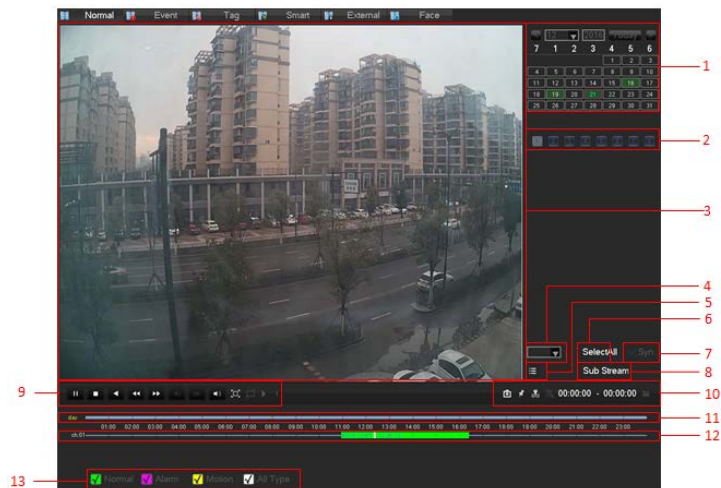

Index	Type	Description
1	Choose the date	Select the time and date to search records.
2	Select channels	Choose the channels for querying.
3	Playback window	Playing video.

4	Time bar channel	When you select the number of channels is more than 4, a channel number value for the timeline display
5	List	Show the status information of channels' video recording within one day by green, red, yellow.
6	All Channel Select	All select, all cancel
7	Synchronization	Achieve the playback of each channel's record is of synchronization in time and of consistency in operations.
8	Sub Stream	Playback with sub stream recording file.
9	Playback control	Full screen, Loop, Stop/Play、Pause、Fast、Slow、Back、Previous Frame、Next Frame.
10	Video Edit Tool	To realize snap, tag, video cut, etc. functions.
11	Event list	Show all events and time
12	Timeline display	Green, red and yellow colors show the video recording in the one day
13	Search Type	128 video records are shown in the list. Type: R—normal record, A—alarm record, M—motion detection record.

Special Functions:

Accurate Playback: support search by time. Enter the desired recording time (hour, minute, second), recording type, channel number, then click **[Play]** button to search out the correct recording file.

Digital zoom: Moving the mouse to the image, then you can scroll the mouse wheel to zoom. (The zoom focus is where the mouse stays)

2.8 Network

2.8.1 Network Setting

[Main Menu]-[NETWORK]-[Basic] to set network:

[IP Address] Default IP is 192.168.1.88.

Note: to POE NVR, there are two network adapters coexisting. You can find LAN1 and LAN2 in [Network Type] list. LAN2 is used for NVR's POE ports. The default IP is 192.168.2.88. If the IP Camera is connected via POE port, the camera's IP address should be in the same segment with LAN2's.

[DHCP] Enable the DHCP to obtain an IP address automatically. If it is enabled, the device will search for a DHCP server, and then assign a dynamic IP address. The dynamic IP address will be displayed in the menu. Enter a static IP address if there is no

DHCP service available. If you are using the advanced feature PPPOE, then the IP/mask/gateway and DHCP are unable to be changed.



Network

2.8.2 WEB Access

Check whether the DVR/NVR is on the network by checking B-Lamp on front panel, light indicates connection, otherwise connection error.

Open one browser and type the NVR/DVR IP and HTTP port into the browser address bar.

E.g. the device's IP is 192.168.1.88 and HTTP port is 80, then you should type <http://192.168.1.88> into the browser address bar.

The device's IP is 192.168.1.88 and HTTP port is 90, then you should type <http://192.168.1.88:90> into the browser address bar.

P2P: Access into **[Main Menu]-[APP]-[P2P]** to get the P2P ID and password. The P2P website address is www.atvsip.com

Note: the first time accessing the P2P website need to install ActiveX. Please allow to install or install it manually. (The setting steps please refer to "IE ActiveX Installation Guide").

2.8.3 Client Access

Mobile Phone Application Access

1、 Turn on the device power, you will find a 'Startup Wizard' displayed on your monitor. Scan the corresponding QR code to download the app.

Note: we support Android system and IOS system.

2、 Run the app and press the button '+ Device' to add new devices.

Note: the detail operation please refer to "help" built in the application.

CMS Remote Access

1、 Install CMS on your computer.

2、 Access into **[Resource Management]-[Device Manage]** to search, add, delete, modify IP equipment. Enter device name, port, IP address, account and password to manual add equipment.

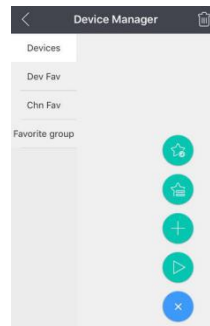

Device Manage

Device Manage

Group Manage

TV Wall

Encoder

Decoder

Device Online

Add

Refresh

<input type="checkbox"/>	Index	IP	Style	Port	Serial number
<input type="checkbox"/>	1	10.12.4.17	IP Camera	8000	
<input type="checkbox"/>	2	10.12.4.36	IP Camera	8000	
<input type="checkbox"/>	3	10.12.4.39	DVR	8000	
<input type="checkbox"/>	4	10.12.4.62	DVR	8000	
<input type="checkbox"/>	5	10.12.4.72	ZL_JVA_CNT	8000	03115807723231147
<input type="checkbox"/>	6	10.12.4.89	NVR_832E	8000	00252a0c

Managed Devices

Del Device

Add Device

search

<input type="checkbox"/>	Index	IP	Name	Style	Channel	Alarm	Port	Status	Operate
<input type="checkbox"/>	1	10.12.4.133	10.12.4.133	Encoder	16	16	8000	Online	Delete <input type="checkbox"/> Modify <input type="checkbox"/> Operate <input type="checkbox"/>

Device Manage

Note:

- 1、 You can find the CMS software in the CD or you can ask the agency where you bought to get the software.
- 2、 The detail operation please refer to the CMS user manual.

3 Statement

- This manual describes basic operations. More details please refer to the main manual found in the CD
- Any doubt or dispute in product description, the company interpretation will ultimately prevail.
- This Quick Setup Guide is for quick reference to certain DVR/NVR models, the specific operation of each product is not listed, when you have encountered any difficult problems, please contact us.

ZK Building, Wuhe Road, Gangtou, Bantian, Buji Town,
Longgang District, Shenzhen China 518129

Tel: +86 755-89602345

Fax: +86 755-89602394

www.zkteco.com

